

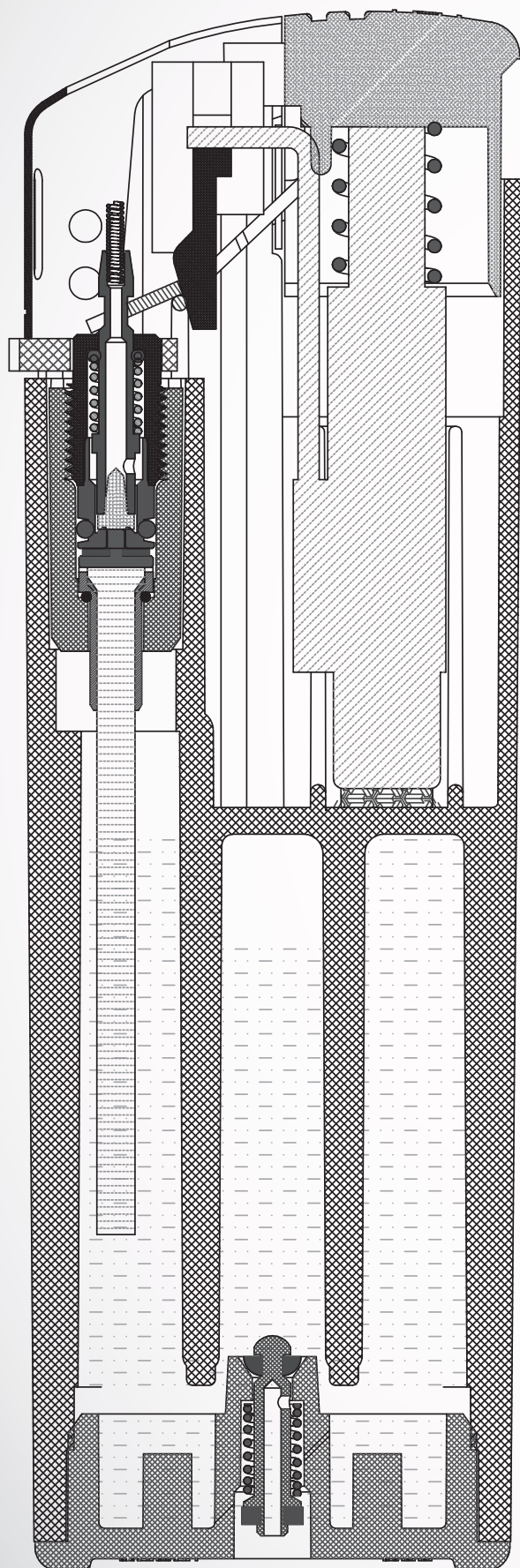

Hot and Elegant

Advertising

The lighter specialist



TOM® Feuerzeuge

Führend in Qualität und Sicherheit

- ✓ TÜV-geprüfte Sicherheit mit GS-Zeichen bei Volumenprodukten
- ✓ ISO 9001 Zertifizierung der Produktionsstätten
- ✓ Kindergesichert nach EN 13869
- ✓ Produktzertifizierung nach ISO 9994
- ✓ Ergonomische Form für optimalen Bedienkomfort
- ✓ Einteilige High-Tech-Konstruktion
- ✓ Regulierbare Sicherheitsflamme
- ✓ Außergewöhnliche Modellvielfalt

TOM® Lighters

Leading in quality and safety

- ✓ TÜV safety tested incl. GS-mark on high selling items
- ✓ ISO 9001 certified production facilities
- ✓ Child-resistant in compliance with EN 13869
- ✓ ISO 9994 certified products
- ✓ Ergonomic design and high user friendliness
- ✓ Single piece high tech structure
- ✓ Adjustable safety flame
- ✓ Great variety of products

Briquets TOM®

Qualité et sécurité de pointe

- ✓ Avec homologation TÜV / GS (sécurité contrôlée)
- ✓ Les sites de production certifiés ISO 9001
- ✓ Sécurité enfants selon EN 13869
- ✓ Les produits certifiés ISO 9994
- ✓ Forme ergonomique pour le plus grand confort d'utilisation
- ✓ Construction monobloc high-tech
- ✓ Flamme de sûreté réglable
- ✓ Grande diversité de modèles



*

Beyond Safety

Sicherheitsflamme ✓

Durch die neue **Fix Flame Technologie** wird die Flammenhöhe im Produktionsprozess fest eingestellt. Eine hohe Flammenbildung während der Nutzung wird dadurch verhindert und die Sicherheit erhöht.

Safety Flame ✓

Due to the new **Fix Flame technology**, the flame height is automatically adjusted in the production process. This prevents the lighter to produce a high flame during use and increases safety to the consumer.

Hitzebeständig ✓

Durch den im **NY-2** verwendeten High-tech-Kunststoff **Polyoximethylen [POM]** und die moderne Konstruktion wird die im internationalen Sicherheitsstandard **ISO 9994** geforderte Temperaturbeständigkeit von 65 °C bei Weitem übertraffen.

Das **NY-2 Fix Flame** Feuerzeug ist geeignet für Temperaturen bis zu **75 °C**.

Heat resistance ✓

Due to the high-tech **Polyoximethylen [POM]** material and the advanced design, the new **NY-2** surpasses the requirements of the international safety standard **ISO 9994** in regards to the required 65 °C temperature resistance.

The **NY-2** can withstand temperatures up to **75 °C**.

Gasinhalt ✓

Durch den aus **POM** gefertigten Tank, erhöht sich aufgrund der dünnen Wände der Gasinhalt.

Gas capacity ✓

The **POM** gas tank allows a higher gas capacity because the material is thinner compared with a regular lighter.

Stoßfest ✓

Durch den aus **POM** gefertigten **stoßfesten Boden [Shock-Proof-Bottom]** wird die Sicherheit beim Herunterfallen des Feuerzeuges erhöht.

Impact resistance ✓

The **Shock-Proof Bottom** protects the lighter body when dropping by absorbing shocks on the suspension bottom plate, made of **POM**.

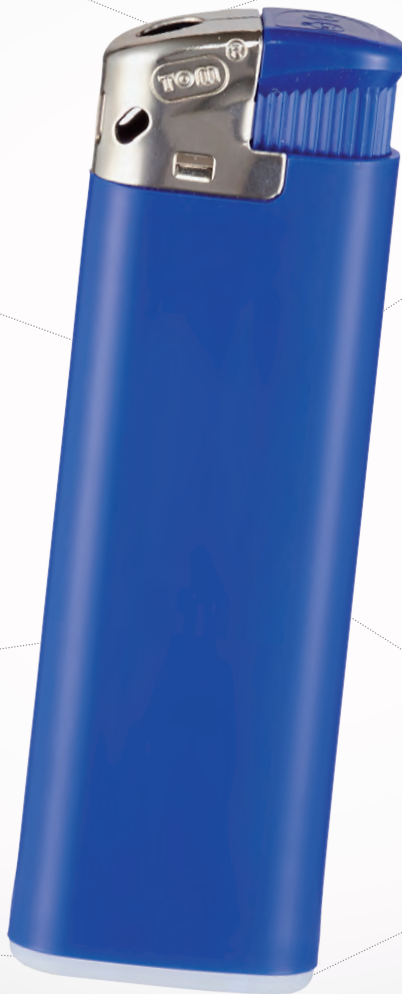

NY-2 Matt Fix Flame

Printable Space: 14 x 48 mm

Tray

20 x 50
1000

Matt



MATT WHITE CHROME CAP

11985 NY-2 01

MATT RED CHROME CAP

10388 NY-2 02

MATT BLUE CHROME CAP

11986 NY-2 03

MATT BLACK CHROME CAP

10382 NY-2 06

EB-15 HC

Printable Space: 13 x 52 mm

Tray 20 x 50 1000



EB-15 HC LED

Printable Space: 13 x 52 mm

LED Tray 20 x 50 1000



EB-15 HC Opener

Printable Space: 13 x 52 mm

Opener Tray 20 x 50 1000



EB-15 Metallic

Printable Space: 13 x 52 mm

Tray

20 x 50
1000



EB-15 Metallic LED

Printable Space: 13 x 52 mm

LED

Tray

20 x 50
1000



EB-15 Frozen

Printable Space: 13 x 52 mm

Tray

20 x 50
1000



EB-15 Coloured Knob

Printable Space: 13 x 52 mm

Tray

20 x 50
1000



HC BLACK RED KNOB

10756 EB-15 CK 02

HC BLACK BLUE KNOB

10757 EB-15 CK 03

HC BLACK YELLOW KNOB

10758 EB-15 CK 04

HC BLACK GREEN KNOB

10759 EB-15 CK 05

EB-15 Harlekin

Printable Space: 13 x 56 mm

Tray

20 x 50
1000



HC PINK / BLUE / YELLOW

10322 EB-15 Harlekin

HC BLUE / PINK / ORANGE

HC YELLOW / GREEN / BLUE

HC GREEN / ORANGE / PINK

HC ORANGE / YELLOW / GREEN

5 Colours
One Set

EB-15 Coloured Cap / Gold Cap

Printable Space: 13 x 52 mm

Tray

20 x 50
1000

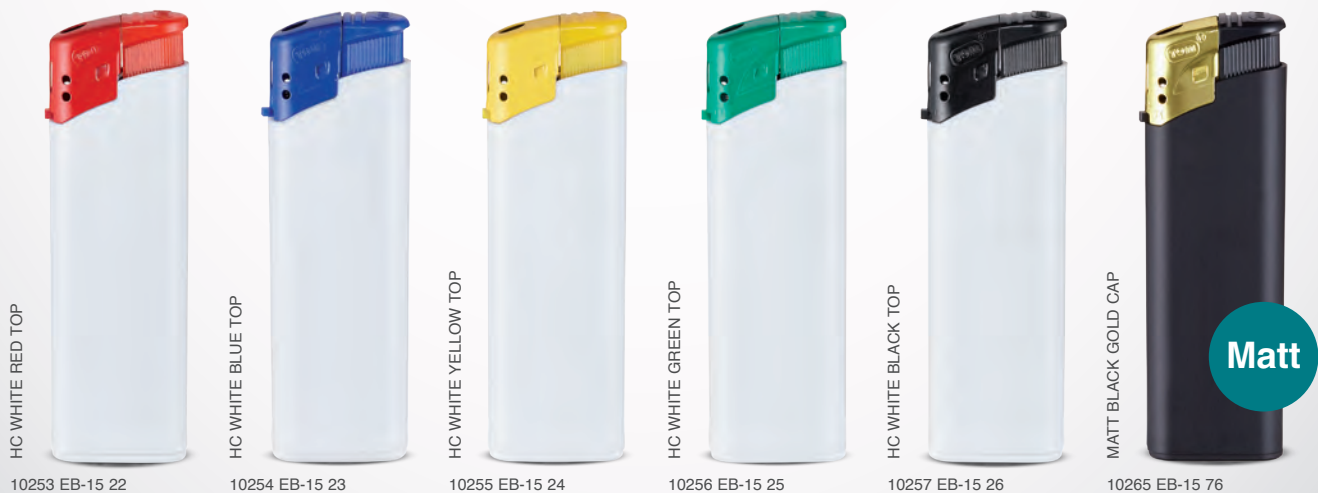

HC WHITE RED TOP

10253 EB-15 22

HC WHITE BLUE TOP

10254 EB-15 23

HC WHITE YELLOW TOP

10255 EB-15 24

HC WHITE GREEN TOP

10256 EB-15 25

HC WHITE BLACK TOP

10257 EB-15 26

MATT BLACK GOLD CAP

10265 EB-15 76

Matt

EB-15 Glossy Metallic

Printable Space: 13 x 52 mm

Tray 20 x 50 1000

New



EB-15 HC Mini

Printable Space: 13 x 35 mm

Tray 20 x 50 1000



EB-4 HC

Printable Space: 10 x 52 mm

Tray 20 x 50 1000

New



EB-54 HC / Metallic Turbo

Printable Space: 14 x 52 mm

Turbo

Tray

20 x 50
1000



HC BLACK BLACK TOP

12277 EB-54 06

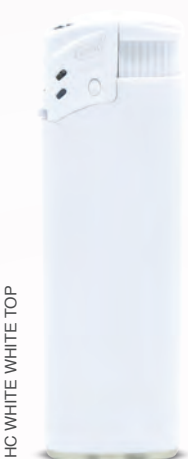

HC WHITE WHITE TOP

12278 EB-54 01



METALLIC SILVER SILVER TOP

12279 EB-54 49

EB-17 Metallic LED

Printable Space: Tank 4 x 40 mm / Body 5 x 40 mm

LED

Tray

20 x 50
1000



METALLIC RED CHROME CAP

10287 EB-17 LED 42



METALLIC BLUE CHROME CAP

10288 EB-17 LED 43



METALLIC GREEN CHROME CAP

10289 EB-17 LED 45



METALLIC BLACK CHROME CAP

10290 EB-17 LED 46



METALLIC SILVER CHROME CAP

10291 EB-17 LED 49

EB-18 Neon Colour

Printable Space: 11 x 45 mm

Tray

20 x 50
1000

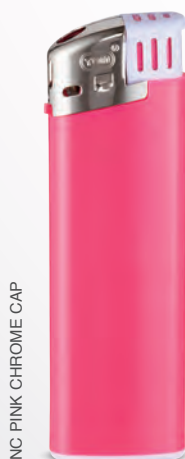

NC PINK CHROME CAP

11855 EB-18 NC 07



NC BLUE CHROME CAP

11852 EB-18 NC 03



NC YELLOW CHROME CAP

11853 EB-18 NC 04



NC GREEN CHROME CAP

11854 EB-18 NC 05

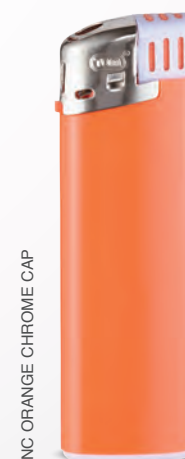

NC ORANGE CHROME CAP

11856 EB-18 NC 08

EB-51 HC

Printable Space: 13 x 52 mm

Tray 20 x 50 1000



EB-52 HC LED

Printable Space: 13 x 52 mm

LED Tray 20 x 50 1000



SM-3 HC

Printable Space: 13 x 52 mm

Slider Tray 20 x 50 1000



SM-3 Metallic / Matt

Printable Space: 13 x 52 mm

Slider Tray 20 x 50 1000



QM-506 TC

Printable Space: 13 x 52 mm

Tray 20 x 50 1000



NM-1 Harlekin

Printable Space: 13 x 52 mm

Tray 20 x 50 1000

New



NM-1 HC

Printable Space: 13 x 52 mm

Tray 20 x 50
1000



NM-1 HC Opener

Printable Space: 13 x 52 mm

Opener Tray 20 x 50
1000



NM-1 TC

Printable Space: 13 x 52 mm

Tray 20 x 50
1000



BB-11 HC

Printable Space: 14 x 52 mm

Display 6 x 16
96

New



BB-2 HC

Printable Space: 15 x 45 mm

Display 12 x 20
240



BB-8 HC

Printable Space: 15 x 50 mm

Display 12 x 20 240



BB-8 Metallic FT

Printable Space: 15 x 50 mm

Flexi Display 12 x 20 240



BB-580 HC

Printable Space: 15 x 35 mm

Display 12 x 20
240



**Soft
Flame**

The TOM BB Series

The perfect lighter for fireplaces and candles



BB-333 Metallic

Printable Space: 6 x 30 mm

Box 6 x 40 240

BB-222 Aluminium

Printable Space: 10 x 30 mm

Display 12 x 20 240

New



EB-19 Aluminium

Printable Space: 15 x 50 mm

Tray

20 x 10
200



ALUMINIUM WHITE BLACK KNOB

10919
EB-19 Aluminium 01



ALUMINIUM BLACK BLACK KNOB

10927
EB-19 Aluminium 06

EB-077 Metal

Printable Space: 8 x 58 mm

Slider

Gift
Box

10 x 10
100



HC WHITE

12117 EB-077 01



METALLIC SILVER

12120 EB-077 49



EB-036 Metal Jet

Printable Space: 25 x 35 mm

Jet

Gift
Box

10 x 10
100



MATT BLACK

12122 EB-036 76



METALLIC SILVER

12121 EB-036 49



EB-062 Metal

Printable Space: 30 x 30 mm

Box 20 x 10 200



JB-1 Metallic / Matt Jet

Printable Space: 35 x 25 mm

Jet Display 12 x 20 240



EB-055 Metal

Printable Space: 15 x 35 mm

Slider Turbo Tray 20 x 10 200

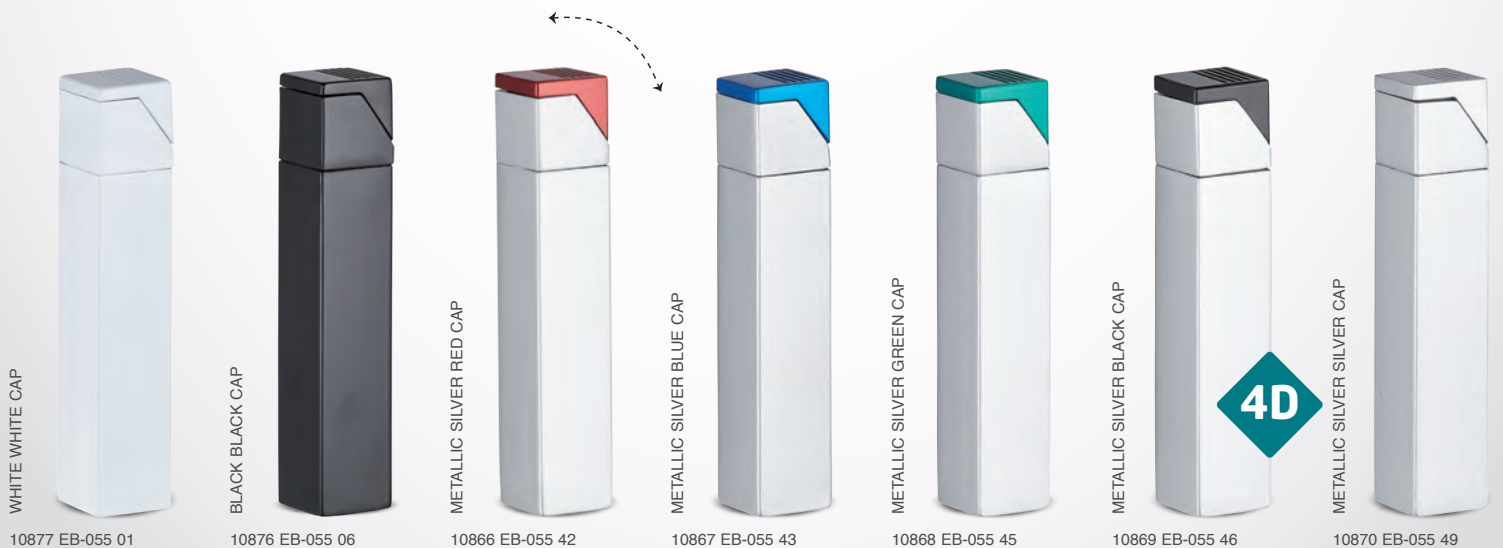



EB-052 Metall

Luxury metal lighter with Turbo-flame

EB-052 Metal
Printable Space: 22 x 50 mm

Turbo Gift Box 10 x 10 100



METALLIC SILVER



11988-01 EB-052 49

EB-050 Metal Silver

Printable Space: 20 x 50 mm

Window Box Display 10 x 10 100

New



METALLIC SILVER

12260 EB-050 49



EB-050 Metal Black

Printable Space: 20 x 50 mm

Window Box Display 10 x 10 100

New

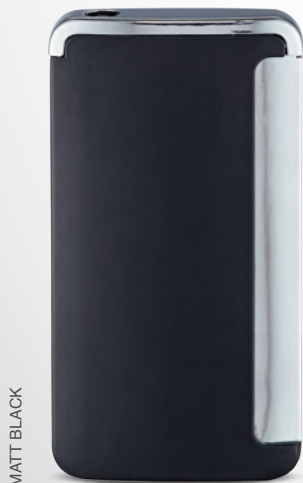

MATT BLACK

12259 EB-050 06





360° WERBUNG

- ✓ Hohe Haltbarkeit aufgrund kratzfester Labelfolie und optimierter Klebetechnik
- ✓ Verschiedene Druckverfahren wie Offset- und Flexodruck
- ✓ Grenzenlose Farbauswahl bis hin zu fotorealistischen Motiven
- ✓ Integrierte EAN-Codierung möglich

360° ADVERTISING

- ✓ High stability through scratch-proof label film and optimized adhesive technology
- ✓ Printing methods: Flexo and Offset
- ✓ Unlimited choice of colours for photo-realistic designs
- ✓ Integrated EAN encoding